

# 3911/3912/3914 .156" (3.96mm) PITCH CRIMP TERMINAL

Features:

unit:mm

- \* THICKNESS: 0.25mm
- \* MAT'L: BRASS OR PHOSPHOR BRONZE TIN PLATED
- \* MATES WITH: 3960 SERIES HOUSING
- \* ACCEPTS WITH: 3961 3962 SERIES WAFER

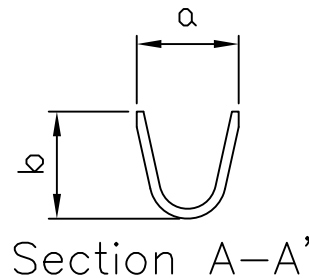

| P/N  | a    | b    | c    | d    |
|------|------|------|------|------|
| 3911 | 4.00 | 3.90 | 2.40 | 2.30 |
| 3912 | 4.00 | 3.90 | 3.00 | 2.80 |
| 3914 | 5.00 | 4.90 | 3.00 | 2.90 |

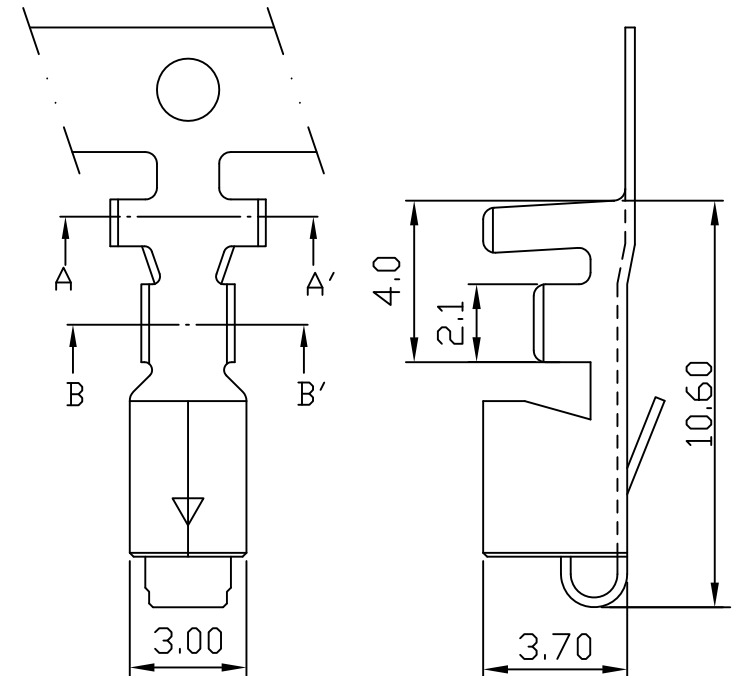
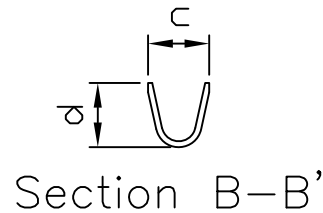

| PART NO. | WIRE RANGE  | INSULATION O.D. | MATERIAL              | FINISH     | QTY/REEL |
|----------|-------------|-----------------|-----------------------|------------|----------|
| 3911     | AWG #18-#22 | ø3.7~ø1.5mm     | BRASS/PHOSPHOR BRONZE | Tin-plated | 4500     |
| 3912     | AWG #16-#18 | ø4.0~ø3.7mm     | BRASS/PHOSPHOR BRONZE | Tin-plated | 3500     |
| 3914     | AWG #16-#18 | ø4.0~ø3.7mm     | BRASS/PHOSPHOR BRONZE | Tin-plated | 4000     |